

## Class 150 weldneck forged flange

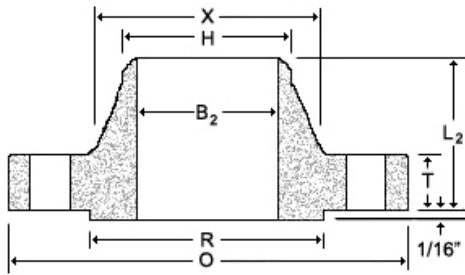

The welding neck flange is normally referred to as the "high hub" Flange. It is designed to transfer stresses to the pipe, thereby reducing high stress concentrations at the base of the Flange.

The welding neck flange is the best designed butt-welded flange

The welding neck flange is the best designed butt-welded flange of those currently available because of its inherent structural value. It is expensive because of the design.

Weldneck forged flange

Nom. Pipe Size	O	T	T <sub>J</sub>	R	X	#/Dia of Holes <sup>a</sup>	Bolt Circle Dia	B	B <sub>2</sub> <sup>b</sup>	B <sub>3</sub>	H	L	L <sub>2</sub>	L <sub>3</sub> <sup>c</sup>	r	D	Thr
½	3.5	0.38	0.44	1.38	1.19	4-0.62	2.38	0.88	0.62	0.9	0.84	0.56	1.81	0.62	0.12	0.38	0.62
¾	3.88	0.44	0.5	1.69	1.5	4-0.62	2.75	1.09	0.82	1.11	1.05	0.56	2	0.62	0.12	0.44	0.62
1	4.25	0.5	0.56	2	1.94	4-0.62	3.12	1.36	1.05	1.38	1.32	0.62	2.12	0.69	0.12	0.5	0.69
1¼	4.62	0.56	0.62	2.5	2.31	4-0.62	3.5	1.7	1.38	1.72	1.66	0.75	2.19	0.81	0.19	0.56	0.81
1½	5	0.62	0.69	2.88	2.56	4-0.62	3.88	1.95	1.61	1.97	1.9	0.81	2.38	0.88	0.25	0.62	0.88
2	6	0.69	0.75	3.62	3.06	4-0.75	4.75	2.44	2.07	2.46	2.38	0.94	2.44	1	0.31	0.69	1
2½	7	0.81	0.88	4.12	3.56	4-0.75	5.5	2.94	2.47	2.97	2.88	1.06	2.69	1.12	0.31	0.75	1.12
3	7.5	0.88	0.94	5	4.25	4-0.75	6	3.57	3.07	3.6	3.5	1.12	2.69	1.19	0.38	0.81	1.19
3½	8.5	0.88	0.94	5.5	4.81	8-0.75	7	4.07	3.55	4.1	4	1.19	2.75	1.25	0.38	0.88	1.25
4	9	0.88	0.94	6.19	5.31	8-0.75	7.5	4.57	4.03	4.6	4.5	1.25	2.94	1.31	0.44	0.94	1.31
5	10	0.88	0.94	7.31	6.44	8-0.88	8.5	5.66	5.05	5.69	5.56	1.38	3.44	1.44	0.44	0.94	1.44
6	11	0.94	1	8.5	7.56	8-0.88	9.5	6.72	6.07	6.75	6.63	1.5	3.44	1.56	0.5	1.06	1.56
8	13.5	1.06	1.12	10.62	9.69	8-0.88	11.75	8.72	7.98	8.75	8.63	1.69	3.94	1.75	0.5	1.25	1.75
10	16	1.12	1.19	12.75	12	12-1.00	14.25	10.88	10.02	10.92	10.8	1.88	3.94	1.94	0.5	1.31	1.94
12	19	1.19	1.25	15	14.38	12-1.00	17	12.88	12	12.92	12.8	2.12	4.44	2.19	0.5	1.56	2.19
14	21	1.31	1.38	16.25	15.75	12-1.12	18.75	14.14	13.25	14.18	14	2.19	4.94	3.12	0.5	1.63	2.25
16	23.5	1.38	1.44	18.5	18	16-1.12	21.25	16.16	15.25	16.19	16	2.44	4.94	3.44	0.5	1.75	2.5
18	25	1.5	1.56	21	19.88	16-1.25	22.75	18.18	17.25	18.2	18	2.62	5.44	3.81	0.5	1.94	2.69
20	27.5	1.62	1.69	23	22	20-1.25	25	20.2	19.25	20.25	20	2.81	5.62	4.06	0.5	2.13	2.88
22	29.5	1.75	1.81	25.25	24.25	20-1.38	27.25	22.22	21.25	22.25	22	3.07	5.82	4.25	0.5	2.38	3.13
24	32	1.81	1.88	27.25	26.12	20-1.38	29.5	24.25	23.25	24.25	24	3.19	5.94	4.38	0.5	2.5	3.25

*Dimensions are in inches.*

(a)- Bolt hole diameter 1/8 in. larger than bolt diameter.

(b)- Standard bore dimensions provided. See bore chart for other wall thicknesses.

(c)- This dimension is commonly associated with "true" lap joints. Industry standard is to make to the slip on length through the hub.

We are a professional flange, forged flange, stainless flange, carbon flange manufacturer in china.

flange

flanges

flange