

ANSI B16.5 Class 150 Threaded forged flange

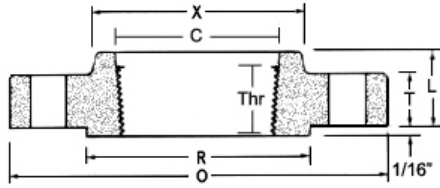

The threaded flange is similar to the slip-on flange, but the bore is threaded. Its chief merit is that it can be assembled without welding, explaining its use in low pressure services at ordinary atmospheric temperatures and in highly explosive areas where welding create a hazard.

Threaded forged flange

Nom. Pipe Size	O	T	T _J	R	X	#/Dia of Holes ^a	Bolt Circle Dia	B	B ₂ ^b	B ₃	H	L	L ₂	L ₃ ^c	r	D	Thr
½	3.5	0.38	0.44	1.38	1.19	4-0.62	2.38	0.88	0.62	0.9	0.84	0.56	1.81	0.62	0.12	0.38	0.62
¾	3.88	0.44	0.5	1.69	1.5	4-0.62	2.75	1.09	0.82	1.11	1.05	0.56	2	0.62	0.12	0.44	0.62
1	4.25	0.5	0.56	2	1.94	4-0.62	3.12	1.36	1.05	1.38	1.32	0.62	2.12	0.69	0.12	0.5	0.69
1¼	4.62	0.56	0.62	2.5	2.31	4-0.62	3.5	1.7	1.38	1.72	1.66	0.75	2.19	0.81	0.19	0.56	0.81
1½	5	0.62	0.69	2.88	2.56	4-0.62	3.88	1.95	1.61	1.97	1.9	0.81	2.38	0.88	0.25	0.62	0.88
2	6	0.69	0.75	3.62	3.06	4-0.75	4.75	2.44	2.07	2.46	2.38	0.94	2.44	1	0.31	0.69	1
2½	7	0.81	0.88	4.12	3.56	4-0.75	5.5	2.94	2.47	2.97	2.88	1.06	2.69	1.12	0.31	0.75	1.12
3	7.5	0.88	0.94	5	4.25	4-0.75	6	3.57	3.07	3.6	3.5	1.12	2.69	1.19	0.38	0.81	1.19
3½	8.5	0.88	0.94	5.5	4.81	8-0.75	7	4.07	3.55	4.1	4	1.19	2.75	1.25	0.38	0.88	1.25
4	9	0.88	0.94	6.19	5.31	8-0.75	7.5	4.57	4.03	4.6	4.5	1.25	2.94	1.31	0.44	0.94	1.31
5	10	0.88	0.94	7.31	6.44	8-0.88	8.5	5.66	5.05	5.69	5.56	1.38	3.44	1.44	0.44	0.94	1.44
6	11	0.94	1	8.5	7.56	8-0.88	9.5	6.72	6.07	6.75	6.63	1.5	3.44	1.56	0.5	1.06	1.56
8	13.5	1.06	1.12	10.62	9.69	8-0.88	11.75	8.72	7.98	8.75	8.63	1.69	3.94	1.75	0.5	1.25	1.75
10	16	1.12	1.19	12.75	12	12-1.00	14.25	10.88	10.02	10.92	10.8	1.88	3.94	1.94	0.5	1.31	1.94
12	19	1.19	1.25	15	14.38	12-1.00	17	12.88	12	12.92	12.8	2.12	4.44	2.19	0.5	1.56	2.19
14	21	1.31	1.38	16.25	15.75	12-1.12	18.75	14.14	13.25	14.18	14	2.19	4.94	3.12	0.5	1.63	2.25
16	23.5	1.38	1.44	18.5	18	16-1.12	21.25	16.16	15.25	16.19	16	2.44	4.94	3.44	0.5	1.75	2.5
18	25	1.5	1.56	21	19.88	16-1.25	22.75	18.18	17.25	18.2	18	2.62	5.44	3.81	0.5	1.94	2.69
20	27.5	1.62	1.69	23	22	20-1.25	25	20.2	19.25	20.25	20	2.81	5.62	4.06	0.5	2.13	2.88
22	29.5	1.75	1.81	25.25	24.25	20-1.38	27.25	22.22	21.25	22.25	22	3.07	5.82	4.25	0.5	2.38	3.13
24	32	1.81	1.88	27.25	26.12	20-1.38	29.5	24.25	23.25	24.25	24	3.19	5.94	4.38	0.5	2.5	3.25

Dimensions are in inches.

- (a)- Bolt hole diameter 1/8 in. larger than bolt diameter.
- (b)- Standard bore dimensions provided. See bore chart for other wall thicknesses.
- (c)- This dimension is commonly associated with "true" lap joints. Industry standard is to make to the slip on length through the hub.

We are a professional flange, forged flange, stainless flange, carbon flange manufacturer in china.

flange

flanges

flange