

ANSI B16.5 Class 1500 Socket weld forged flange

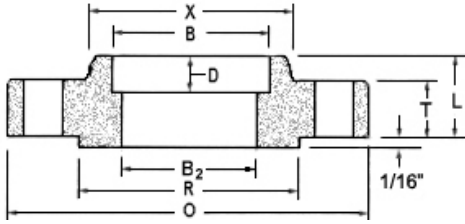

The socket welding flange is similar to a slip-on flange except it has a bore and a counter bore dimension. The counter bore is slightly larger than the O.D. of the matching pipe, allowing the pipe to be inserted into the flange similar to a slip-on flange. The diameter of the smaller bore is the same as the I.D. of the matching pipe. A restriction is built into the bottom of the bore which sets as a shoulder for the pipe to rest on. This eliminates any restriction in flow when using a socket welding flange.

Socket weld forged flange

Nom. Pipe Size	O	T	R	X	#/Dia of Holes ^a	Bolt Circle Dia	B	B ₂ ^b	B ₃	H	L	L ₂	L ₃ ^c	r	C	D	Thr
3/4	5.12	1	1.69	1.75	4-0.88	3.5	1.09	To be specified by Purchaser.	1.11	1.05	1.38	2.75	1.38	0.12	1.14	0.44	1
1	5.88	1.12	2	2.06	4-1.00	4	1.36		1.38	1.32	1.62	2.88	1.62	0.12	1.41	0.5	1.12
1 1/4	6.25	1.12	2.5	2.5	4-1.00	4.38	1.7		1.72	1.66	1.62	2.88	1.62	0.19	1.75	0.56	1.19
1 1/2	7	1.25	2.88	2.75	4-1.12	4.88	1.95		1.97	1.9	1.75	3.25	1.75	0.25	1.99	0.62	1.25
2	8.5	1.5	3.63	4.12	8-1.00	6.5	2.44		2.46	2.38	2.25	4	2.25	0.31	2.5	0.69	1.5
2 1/2	9.62	1.62	4.13	4.88	8-1.12	7.5	2.94		2.97	2.88	2.5	4.12	2.5	0.31	3	0.75	1.88
3	10.5	1.88	5	5.25	8-1.25	8		3.6	3.5	4.62	2.88	0.38
4	12.25	2.12	6.19	6.38	8-1.38	9.5		4.6	4.5	4.88	3.56	0.44
5	14.75	2.88	7.31	7.75	8-1.63	11.5		5.69	5.56	6.12	4.12	0.44
6	15.5	3.25	8.5	9	12-1.50	12.5		6.75	6.63	6.75	4.69	0.5
8	19	3.62	10.63	11.5	12-1.75	15.5		8.75	8.63	8.38	5.62	0.5
10	23	4.25	12.75	14.5	12-2.00	19		10.92	10.75	10	7	0.5
12	26.5	4.88	15	17.75	16-2.12	22.5		12.92	12.75	11.12	8.62	0.5
14	29.5	5.25	16.25	19.5	16-2.38	25		14.18	14	11.75	9.5	0.5
16	32.5	5.75	18.5	21.75	16-2.63	27.75		16.19	16	12.25	10.25	0.5
18	36	6.38	21	23.5	16-2.88	30.5		18.2	18	12.88	10.88	0.5
20	38.75	7	23	25.25	16-3.12	32.75		20.25	20	14	11.5	0.5
24	46	8	27.25	30	16-3.63	39		24.25	24	16	13	0.5

Dimensions are in inches.

- (a)- Bolt hole diameter 1/8 in. larger than bolt diameter.
- (b)- Standard bore dimensions provided. See bore chart for other wall thicknesses.
- (c)- This dimension is commonly associated with "true" lap joints. Industry standard is to make to the slip on length through the hub.

We are a professional flange, forged flange, stainless flange, caron flange manufacturer in china.

[flange](#)

[flanges](#)

[flange](#)