

Welding Neck Orifice Class 300 Threaded Flanges

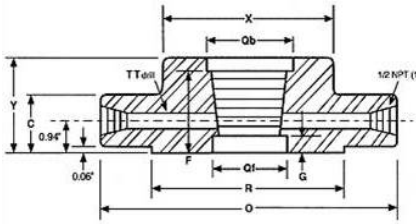

The welding neck flange is normally referred to as the "high hub" Flange. It is designed to transfer stresses to the pipe, thereby reducing high stress concentrations at the base of the Flange. The welding neck flange is the best designed butt-welded flange of those currently available because of its inherent structural value. It is expensive because of the design.

Threaded Orifice Class 300 flange

												Drilling	
Nom Size	OD	Thickne ss	OD of RF	Dia at Base	LTH	OD of Counter Bore		Counter Bore Depth (from face)		Dia of Pressure Connectio n	Bolt Circle	Bolt Dia	
						Qb ⁽²⁾	Qf ⁽³⁾	F	G				TT
	O	C	R	X	Y								
in.	1	4.88	1.5	2	2.12	1.88	1.41	1.3	1.44	0.75	1/4	3.5	5/8
mm.		124	38.1	50.8	53.8	47.8	35.8	33	36.6	19.1	6.4	88.9	15.9
in.	1 1/2	6.12	1.5	2.88	2.75	1.88	1.99	1.89	1.47	0.72	1/4	4.5	3/4
mm.		155.4	38.1	73.2	69.9	47.8	50.5	48	37.3	18.3	6.4	114.3	19.1
in.	2	6.5	1.5	3.62	3.31	1.94	2.5	2.36	1.5	0.69	1/4	5	5/8
mm.		165.1	38.1	91.9	84.1	49.3	63.5	59.9	38.1	17.5	6.4	127	15.9
in.	2 1/2	7.5	1.5	4.12	3.94	2	3	2.84	1.75	0.56	1/4	5.88	3/4
mm.		190.5	38.1	104.6	100.1	50.8	76.2	72.1	44.5	14.2	6.4	149.4	19.1
in.	3	8.25	1.5	5	4.62	2.06	3.63	3.46	1.81	0.56	3/8	6.62	3/4
mm.		209.6	38.1	127	117.3	52.3	92.2	87.9	46	14.2	9.5	168.1	19.1
in.	4	10	1.5	6.19	5.75	2.12	4.63	4.45	1.88	0.56	1/2	7.88	3/4
mm.		254	38.1	157.2	146.1	53.8	117.6	113	47.8	14.2	12.7	200.2	19.1
in.	6	12.5	1.5	8.5	8.12	2.12	6.75	6.57	1.88	0.31	1/2	10.62	3/4
mm.		317.5	38.1	215.9	206.2	53.8	171.5	166.9	47.8	7.9	12.7	269.7	19.1
in.	8	15	1.62	10.62	10.25	2.44	8.75	8.55	2.19	0.44	1/2	13	7/8
mm.		381	41.1	269.7	260.4	62	222.3	217.2	55.6	11.2	12.7	330.2	22.2

(1) Other NPT and SW connections available upon request.

(2) Qb counterbore back.

(3) Qf counterbore face.

flange

forged flange

flanges

flange

www.forgeflange.com