

## Welding Neck Orifice Class 300SO Flanges

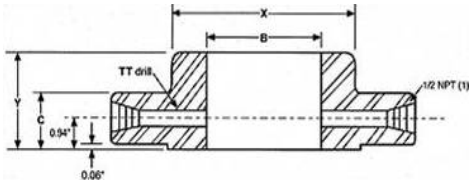

The slip-on flange has a low hub because the pipe slips into the flange prior to welding. It is welded both inside and out to provide sufficient strength and prevent leakage. Slip-on flanges are all bored slightly larger than the O.D. of the matching pipe. They are preferred over welding neck flanges by many users due to their lower initial cost, but final installation cost is probably not much less than that of the welding neck flange because of the additional welding involved.

weld neck orifice 300so flange

									<b>Drilling</b>			
	Nom Size	OD	Thickne ss	OD of RF	Dia at base	Bore	LTH	Dia of Pressure Connection	Bolt Circle	Hole Dia	# of holes	Bolt Dia
		O	C	R	X	B	Y	TT				
<b>in</b>	1	4.88	1.5	2	2.12	1.36	1.88	1/4	3.5	0.69	4	5/8
<b>mm</b>		124	38.1	50.8	53.8	34.5	47.8	6.4	88.9	17.5		15.9
<b>in</b>	1 1/2	6.12	1.5	2.88	2.75	1.95	1.88	1/4	4.5	0.81	4	3/4
<b>mm</b>		155.4	38.1	73.2	69.9	49.5	47.8	6.4	114.3	20.6		19.1
<b>in</b>	2	6.5	1.5	3.62	3.31	2.44	1.94	1/4	5	0.69	8	5/8
<b>mm</b>		165.1	38.1	91.9	84.1	62	49.3	6.4	127	17.5		15.9
<b>in</b>	2 1/2	7.5	1.5	4.12	3.94	2.94	2	1/4	5.88	0.81	8	3/4
<b>mm</b>		190.5	38.1	104.6	100.1	74.7	50.8	6.4	149.4	20.6		19.1
<b>in</b>	3	8.25	1.5	5	4.62	3.57	2.06	3/8	6.62	0.81	8	3/4
<b>mm</b>		209.6	38.1	127	117.3	90.7	52.3	9.5	168.1	20.6		19.1
<b>in</b>	4	10	1.5	6.19	5.75	4.57	2.12	1/2	7.88	0.81	8	3/4
<b>mm</b>		254	38.1	157.2	146.1	116.1	53.8	12.7	200.2	20.6		19.1
<b>in</b>	6	12.5	1.5	8.5	8.12	6.72	2.12	1/2	10.62	0.88	12	3/4
<b>mm</b>		317.5	38.1	215.9	206.2	170.7	53.8	12.7	269.7	22.4		19.1
<b>in</b>	8	15	1.62	10.62	10.25	8.72	2.44	1/2	13	1	12	7/8
<b>mm</b>		381	41.1	269.7	260.4	221.5	62	12.7	330.2	25.4		22.2
<b>in</b>	10	17.5	1.88	12.75	12.62	10.88	2.62	1/2	15.25	1.12	16	1
<b>mm</b>		444.5	47.8	323.9	320.5	276.4	66.5	12.7	387.4	28.4		25.4
<b>in</b>	12	20.5	2	15	14.75	12.88	2.88	1/2	17.75	1.25	16	1 1/8
<b>mm</b>		520.7	50.8	381	374.7	327.2	73.2	12.7	450.9	31.8		28.6
<b>in</b>	14	23	2.12	16.25	16.75	14.14	3	1/2	20.25	1.25	20	1 1/8
<b>mm</b>		584.2	53.8	412.8	425.5	359.2	76.2	12.7	514.4	31.8		28.6
<b>in</b>	16	25.5	2.25	18.5	19	16.16	3.25	1/2	22.5	1.38	20	1 1/4
<b>mm</b>		647.7	57.2	469.9	482.6	410.5	82.6	12.7	571.5	35.1		31.8
<b>in</b>	18	28	2.38	21	21	18.18	3.5	1/2	24.75	1.38	24	1 1/4
<b>mm</b>		711.2	60.5	533.4	533.4	461.8	88.9	12.7	628.7	35.1		31.8
<b>in</b>	20	30.5	2.5	23	23.12	20.2	3.75	1/2	27	1.38	24	1 1/4
<b>mm</b>		774.7	63.5	584.2	587.2	513.1	95.3	12.7	685.8	35.1		31.8
<b>in</b>	24	36	2.75	27.25	27.62	24.25	4.19	1/2	32	1.62	24	1 1/2
<b>mm</b>		914.4	69.9	692.2	701.5	616	106.4	12.7	812.8	41.1		38.1

1. Other NPT and SW connections available upon request.

[flange](#)

[forged flange](#)

[flanges](#)

[flange](#)